

Mil-Spec to Commercial Prefix Guide

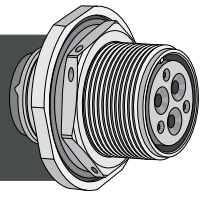

MIL VERSION	SHELL STYLE	COUPLING STYLE	CONTACT TERMINATION	COMMERCIAL VERSION
MIL-DTL-38999 SERIES III				
D38999/20	Wall Mount Receptacle	Threaded	Crimp	TVP00, TVPS00 (AL & SS); CTVP00, CTVPS00 (Composite)
D38999/24	Jam Nut Receptacle	Threaded	Crimp	TV07, TVS07 (AL & SS); CTV00, CTVS00 (Composite)
D38999/26	Straight Plug	Threaded	Crimp	TV06, TVS06 (AL & SS); CTV06, CTVS06 (Composite)
MIL-DTL-38999 SERIES II				
MS27472	Wall Mount Receptacle	Bayonet	Crimp	JT00
MS27497	Wall Mount Receptacle (Back Panel)	Bayonet	Crimp	JTPQ00
MS27499	Box Mount Receptacle	Bayonet	Crimp	JT02
MS27513	Box Mount Receptacle (Grommet)	Bayonet	Crimp	JT02
MS27508	Box Mount Receptacle (Back Panel)	Bayonet	Crimp	JTP02
MS27473	Straight Plug	Bayonet	Crimp	JT06
MS27484	Straight Plug (Grounding Fingers)	Bayonet	Crimp	JTG06
MS27474	Jam Nut Receptacle	Bayonet	Crimp	JT07
MS27500	90 Degree Plug	Bayonet	Crimp	JT08
MIL-DTL-38999 SERIES I				
MS27466	Wall Mount Receptacle	Bayonet	Crimp	LJT00
MS27656	Wall Mount Receptacle (Back Panel)	Bayonet	Crimp	LJTPQ00
MS27496	Box Mount Receptacle	Bayonet	Crimp	LJT02
MS27505	Box Mount Receptacle (Back Panel)	Bayonet	Crimp	LJTP02
MS27467	Straight Plug	Bayonet	Crimp	LJT06
MS27468	Jam Nut Receptacle	Bayonet	Crimp	LJT07
MIL-DTL-26482 SERIES 2				
MS3470	Wall Mount Receptacle (Narrow Flange)	Bayonet	Crimp	MB10
MS3471	Cable Connecting Receptacle	Bayonet	Crimp	MB13
MS3472	Wall Mount Receptacle (Wide Flange)	Bayonet	Crimp	MB11
MS3474	Jam Nut Receptacle	Bayonet	Crimp	MB14
MS3475	Straight Plug (RFI Grounding Fingers)	Bayonet	Crimp	MB18
MS3476	Straight Plug	Bayonet	Crimp	MB16
MIL-DTL-26482 SERIES 1				
MS3110	Wall Mount Receptacle	Bayonet	Solder	UT00
MS3111	Cable Connecting Receptacle	Bayonet	Solder	UT01
MS3112	Box Mount Receptacle	Bayonet	Solder	UT02
MS3114	Jam Nut Receptacle	Bayonet	Solder	UT07
MS3116	Straight Plug	Bayonet	Solder	UT06
MS3120	Wall Mount Receptacle	Bayonet	Crimp	UT00S
MS3121	Cable Connecting Receptacle	Bayonet	Crimp	UT01S
MS3122	Box Mount Receptacle	Bayonet	Crimp	UT02S
MS3124	Jam Nut Receptacle	Bayonet	Crimp	UT07S
MS3126	Straight Plug	Bayonet	Crimp	UT06S
MS3127	Box Mount Receptacle with Dual Mounting Holes	Bayonet	Crimp	MF02
MS3128	Wall Mount Receptacle with Dual Mounting Holes	Bayonet	Crimp	MF00

MIL VERSION	SHELL STYLE	COUPLING STYLE	CONTACT TERMINATION	COMMERCIAL VERSION
MIL-DTL-83723				
M83723/71	Wall Mount Receptacle (Socket Contacts)	Bayonet	Crimp	MB30 (AL); BYG-17, BYK-17 (SS)
M83723/72	Wall Mount Receptacle (Pin Contacts)	Bayonet	Crimp	MB30 (AL); BYG-17, BYK-17 (SS)
M83723/73	Jam Nut Receptacle (Socket Contacts)	Bayonet	Crimp	MB34 (AL); BYG-19, BYK-19 (SS)
M83723/74	Jam Nut Receptacle (Pin Contacts)	Bayonet	Crimp	MB34 (AL); BYG-19, BYK-19 (SS)
M83723/75	Straight Plug (Socket Contacts)	Bayonet	Crimp	MB36 (AL); BYG-10, BYK-10 (SS)
M83723/76	Straight Plug (Pin Contacts)	Bayonet	Crimp	MB36 (AL); BYG-10, BYK-10 (SS)
M83723/77	Straight Plug with RFI Grounding Fingers (Socket Contacts)	Bayonet	Crimp	MB38
M83723/78	Straight Plug with RFI Grounding Fingers (Pin Contacts)	Bayonet	Crimp	MB38
M83723/82	Wall Mount Receptacle (Socket Contacts)	Threaded	Crimp	MT30 (AL); BTG-17, BTK-17 (SS)
M83723/83	Wall Mount Receptacle (Pin Contacts)	Threaded	Crimp	MT30 (AL); BTG-17, BTK-17 (SS)
M83723/84	Jam Nut Receptacle (Socket Contacts)	Threaded	Crimp	MT34 (AL); BTG-19, BTK-19 (SS)
M83723/85	Jam Nut Receptacle (Pin Contacts)	Threaded	Crimp	MT34 (AL); BTG-19, BTK-19 (SS)
M83723/86	Straight Plug (Socket Contacts)	Threaded	Crimp	MT36 (AL); BTG-11, BTK-11 (SS)
M83723/87	Straight Plug (Pin Contacts)	Threaded	Crimp	MT36 (AL); BTG-11, BTK-11 (SS)
M83723/91	Plug with RFI Grounding Fingers (Socket Contacts)	Threaded	Crimp	MT38
M83723/92	Plug with RFI Grounding Fingers (Pin Contacts)	Threaded	Crimp	MT38
M83723/95	Plug with Self-Locking Clutch Plate (Socket Contacts)	Threaded	Crimp	MT37 (AL); BTG-12, BTK-12 (SS)
M83723/96	Plug with Self-Locking Clutch Plate (Pin Contacts)	Threaded	Crimp	MT37 (AL); BTG-12, BTK-12 (SS)
M83723/97	Non-Decoupling Plug with EMI Grounding Spring (Socket Contacts)	Threaded	Crimp	BTG-12F, BTK-12F
M83723/98	Non-Decoupling Plug with EMI Grounding Spring (Pin Contacts)	Threaded	Crimp	BTG-12F, BTK-12F
M83723/66	Quick-Disconnect Plug without Lanyard (Pin Contacts)	Quick-Disconnect	Crimp	MQ36
M83723/67	Quick-Disconnect Plug without Lanyard (Socket Contacts)	Quick-Disconnect	Crimp	MQ36
M83723/68	Quick-Disconnect Plug with Lanyard (Pin Contacts)	Quick-Disconnect	Crimp	MQ35
M83723/69	Quick-Disconnect Plug with Lanyard (Socket Contacts)	Quick-Disconnect	Crimp	MQ35
MIL-DTL-26500				
MS24264	Wall Mount (Threaded)	Threaded	Crimp	ZZY(-)-17
MS24264	Wall Mount (Bayonet)	Bayonet	Crimp	ZZW(-)-17
MS24265	Jam Nut (Threaded)	Threaded	Crimp	ZZY(-)-15
MS24265	Jam Nut (Bayonet)	Bayonet	Crimp	ZZW(-)-15
MS24266	Straight Plug (Threaded)	Threaded	Crimp	ZZY(-)-10
MS24266	Straight Plug (Bayonet)	Bayonet	Crimp	ZZW(-)-10
MS27613	Wall Mount Receptacle (Threaded) - Firewall	Threaded	Crimp	FPK-17
MS27613	Wall Mount Receptacle (Bayonet) - Firewall	Bayonet	Crimp	FYL-17
MS27614	Jam Nut Receptacle (Threaded) - Firewall	Threaded	Crimp	FPK-19
MS27614	Jam Nut Receptacle (Bayonet) - Firewall	Bayonet	Crimp	FYL-19
MS27615	Straight Plug (Threaded) - Firewall	Threaded	Crimp	FPK-11
MS27615	Straight Plug (Bayonet) - Firewall	Bayonet	Crimp	FYL-11
MIL-DTL-5015				
MS3450	Wall Mount Receptacle	Threaded	Crimp	9440
MS3451	Cable Connecting Receptacle	Threaded	Crimp	9441
MS3452	Box Mount Receptacle	Threaded	Crimp	9442
MS3454	Jam Nut Receptacle	Threaded	Crimp	9444
MS3456	Straight Plug	Threaded	Crimp	9446
MS3459	Straight Plug with Self-Locking Coupling Nut	Threaded	Crimp	9816
MIL-DTL-22992 CLASS L				
MS90555	Wall Mount Receptacle	Threaded	Crimp	CL90555
MS90556	Straight Plug	Threaded	Crimp	CL90556
MS90557	Cable Connecting Receptacle	Threaded	Crimp	CL90557
MS90558	Wall Mount Plug	Threaded	Crimp	CL90558